

GOVERNOR ATIYEH



**WELCOME
ABOARD
Air Force One**

MR. ATIYEH



**WELCOME
ABOARD**

Air Force One

*Musical
Entertainment
for the Presidential
Aircraft*



*Welcome Aboard
Air Force One*

Classical Collections 1

Host: George Stone

Symphony No. 4 in E Flat, "Romantic": Scherzo	By: Anton Bruckner Chicago Symphony Orchestra Sir Georg Solti, Conductor London Digital #LDR-71038
Concerto No. 4 in D for Violin, K-218	By: Wolfgang A. Mozart Anne-Sophie Mutter, Violin Philharmonia Orchestra Riccardo Muti, Conductor Angel Digital #DS-37904
Manfred Symphony, Op. 58: Finale	By: Peter I. Tchaikovsky Philharmonia Orchestra Riccardo Muti, Conductor Angel Digital #DS-37752

Countryopolitan 2

Host: Mark Edwards

It's Like Falling In Love (Over and Over)	The Osmond Brothers Elektra/Curb #7-69969-A
Like Nothing Ever Happened	Sylvia RCA #JK-13330
War Is Hell (On the Homefront Too)	T.G. Sheppard Warner Bros./Curb #7-29934
That's What I Get For Thinking	The Kendalls Mercury #76178 DJ
(Sittin' On) The Dock Of The Bay	Waylon & Willie RCA #JK13319
Somewhere Between Right And Wrong	Earl Thomas Conley RCA #JB-13320
You And I	Eddie Rabbitt with Crystal Gayle Elektra #7-69936-A
Riders In The Sky	Roy Clark MCA #DO-2030
Never Picked Cotton	Roy Clark MCA #DO-2030
Hee Haw Polka	Roy Clark MCA #DO-2030
Yesterday When I Was Young	Roy Clark MCA #DO-2030
Under The Double Eagle	Roy Clark ABC #DO-2087/2
(Lost His Love) On Our Last Date	Emmylou Harris Warner Bros. #7-29898
Cherokee Fiddle	Johnny Lee and Friends Full Moon/Asylum #7-69945-A
A Child Of The Fifties	The Statler Brothers Mercury #76184 DJ
Break It To Me Gently	Juice Newton Capitol #B-5148

Easy Listening 3

A Day In The Life Of A Fool	Mantovani London #PS 526
The Winner Takes It All	Franck Pourcel Pathe #2C 068 15.599
In Your Arms	Diana Ross RCA #AFL1 4384 B
After The Lovin'	Ferrante & Teicher United Artists #UA LA 908-H
With These Hands	Matt Monro EMI #OU 2238
Emmanuelle	Peter Nero Arista #AL 4034
Broken Hearted Me	England Dan & John Ford Coley Big Tree #BT 76015
All In Love Is Fair	Hugo Montenegro RCA #APL1 4013
Cry Me A River	Crystal Gayle United Artists #UA LA858 H
The Shadow Of Your Smile	Jack Jones MCA #2 4115
It's My Turn	Motion Picture Soundtrack Orchestra Motown #M8-947M1
Tenderly	Franck Pourcel Pathe #2C 068 15.599
Where Is The Love	Bo Thorpe & Generation II Hindsight #HSR 315B
Charade	Henry Mancini RCA #LSP 4689
Teach Me Tonight	Al Jarreau Warner Bros. #BSK 3576
Love In Every Room	Tony Mottola Project 3 #PR 5025 SD
Feelings	Caravelli Peters International #PLD 1000
Summers Of My Life	Gino Vanelli A&M #SP 4596

The Best of Broadway 4

Host: John Doremus

CATS	Geffin #2GHS 2017
The Jellie Ball	The Cast Orchestra
Mr. Mistoffelees	Wayne Sleep & Paul Nicholas
The Invitation To The Jellie Ball	Finola Hughes & Wayne Sleep
Memory	Etaine Paige
Mungojerrie And Rumpleteazer	John Thornton & Bonnie Langford

Skimbeeshanks The Railway Cat Opening Night	The Company 101 Strings Alshire #S-5246
PIPPIN	Motown #M760L
Corner Of The Sky	John Rubinstein
Kind Of Woman	Jill Clayburgh & Girls
Magic To Do	Ben Vereen & The Players
Morning Glow	John Rubinstein & Chorus
No Time At All	Irene Ryan & The Gang
On The Right Track	Ben Vereen & John Rubinstein
I Guess I'll Miss The Man	Jill Clayburgh
Finale	The Company

Air Time 5

Host: Mike Rapchak

Let's Dance	Benny Goodman Decca #DL 4552
Don't Be That Way	Benny Goodman RCA #CPL1-2470(e)
Loch Lomond	Benny Goodman with Martha Tilton RCA #CPL1-2470(e)
Sing, Sing, Sing	Benny Goodman with Gene Krupa RCA #CPL1-2470(e)
Midnight Sun	Les Brown MCA #2-4070
Down By The Old Mill Stream	Sammy Kaye MCA #2-4027
You've Got Me Crying Again	Sammy Kaye with Ray Michaels & The Kaydets MCA #2-4027
I Understand	Sammy Kaye with Ray Michaels MCA #2-4027
I've Got My Love To Keep Me Warm	Les Brown MCA #2-4070
Baubles, Bangles And Beads	Frank Sinatra Capitol #SW-1069
Dancing In The Dark	Frank Sinatra Capitol #SW-1069
The Last Dance	Frank Sinatra Capitol #SW-1069
Dream	Les Brown MCA #2-4070
I Cried For You	Harry James with Helen Forrest Capitol #STFL-293
Sleepy Lagoon	Harry James Capitol #STFL-293

Command Performance 6

Ray Charles
Host: Mike Rapchak

Hornful Soul	Ray Charles Atlantic #AD 5-3700
You Are My Sunshine	Ray Charles Ahed #TVLP 77028
Heavenly Music	Ray Charles Atlantic #SD 19142
That Lucky Old Sun	Ray Charles London #6.22554
Let The Good Times Roll	Ray Charles Atlantic #AD 5-3700
Don't Set Me Free	Ray Charles London #6.22554
Drift Away	Ray Charles Atlantic #SD 19251
Your Cheatin' Heart	Ray Charles Ahed #TVLP 77028
I Got A Woman	Ray Charles Atlantic #AD 5-3700
A Fool For You	Ray Charles Atlantic #AD 5-3700
Drown In My Own Tears	Ray Charles Atlantic #AD 5-3700
Hallelujah I Love You So	Ray Charles Atlantic #AD 5-3700
I Can't Stop Loving You	Ray Charles Ahed #TVLP 77028
What'd I Say	Ray Charles Atlantic #AD 5-3700
Georgia On My Mind	Ray Charles London #6.22554
Hit The Road Jack	Ray Charles Ahed #TVLP 77028
A Bit Of Soul	Ray Charles Atlantic #AD 5-3700



Welcome Aboard

This pamphlet is designed to help you enjoy your flight aboard the Presidential Aircraft. It includes information on the aircraft, on the modern passenger comfort and convenience items available to you, and a brief discussion of emergency procedures in the unlikely event of a mechanical malfunction.

THE PRESIDENTIAL AIRCRAFT

This aircraft is an Air Force C137. It is a Boeing 707, intercontinental commercial jetliner. Principal differences between a commercial 707 and the C137 are in electronic and communications equipment, conference facilities and other interior furnishings. Average cruising speed for the aircraft is 600 MPH with a maximum range of over 7,000 miles. Wing span of the aircraft is 145 feet 9 inches, the length is 152 feet 11 inches, and the height is 41 feet 10 inches. Maximum gross weight is 336,000 pounds.



COMFORT AND CONVENIENCE

Every effort has been made to make your flight as enjoyable and memorable as possible. Many items are available to you for your comfort and convenience, including an in-flight radio telephone service available on a priority official basis. Communication services are channeled through the radio operations switchboard and removing a handset from the cradle of any telephone will automatically alert the radio operator for prompt service in providing intercom calls, conference calls, or radio-phone communications. When using a telephone, passengers and guests are cautioned to not discuss classified information as these conversations are easily monitored. On the ground, telephone land lines are connected to the aircraft for telephone service. A safe provides limited space for storage of classified material. For entertainment, there are four channels of overhead music, con-

trolled by panels in the stateroom, conference room, staff room, and passenger compartment. Additionally, individual stereo headsets providing selected music are available at each passenger seat. A choice of six channels of the finest recordings from a wide variety of artists can be made. The "Music, in the Air" program assists you to select your type of listening. Other items available to you include stationery packets; playing cards; a variety of magazines; emergency raincoats; sewing kits; an assortment of toilet articles which include razor blades, shaving cream, toothpaste, kleenex, sanitary napkins, after-shave lotion, etc.

PASSENGER SERVICE UNIT

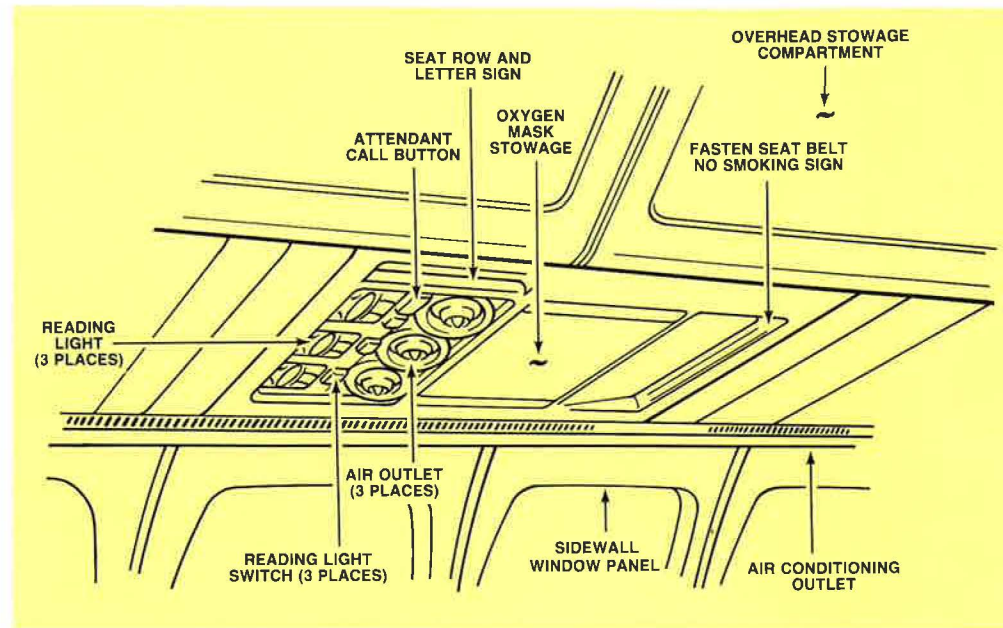

EMERGENCY PROCEDURES

Ground Evacuation

Each crewmember has been assigned to a compartment or section in which he has primary responsibility during emergency situations. You are expected to *follow his directions* for he has been carefully trained to provide the maximum safety and comfort possible for the passengers entrusted to his care.

Evacuation—Ground evacuation is a remote possibility, but evacuation slides are provided at each door exit for such an emergency. The proper method of leaving the aircraft by the evacuation slide is to jump into the slide SEAT first. *Hitting feet first may slow the evacuation and could damage the slide or cause personal injury.*

DOOR EXITS

Two exit doors are located in the forward cabin and two in the rear cabin. All exits are marked by arrows on the diagram.

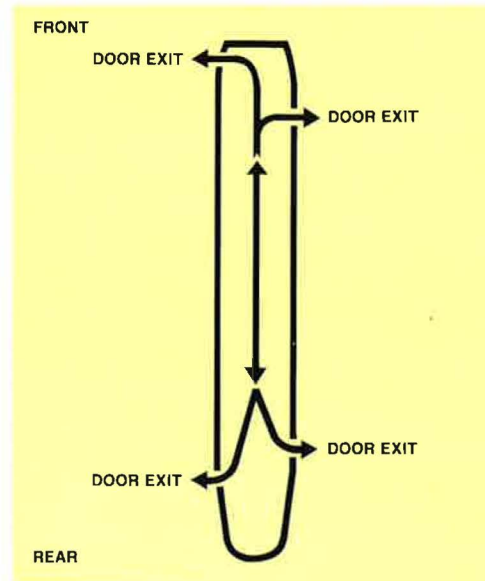

GROUND EVACUATION PROCEDURES: INFLATABLE—ESCAPE SLIDE EJECTION

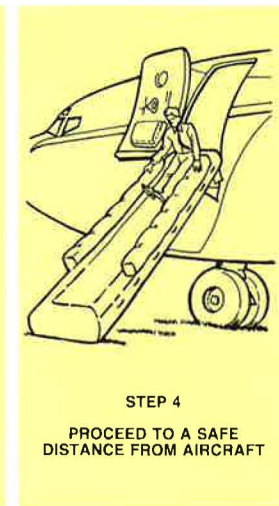
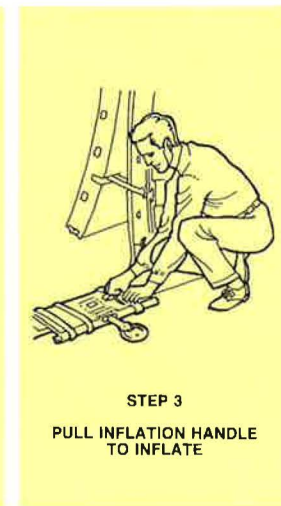
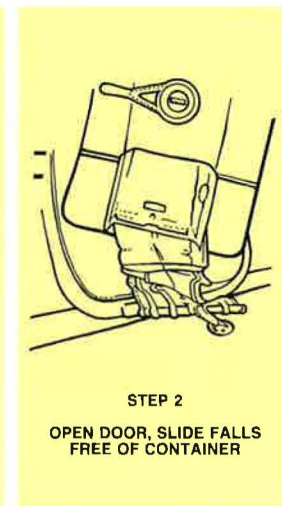
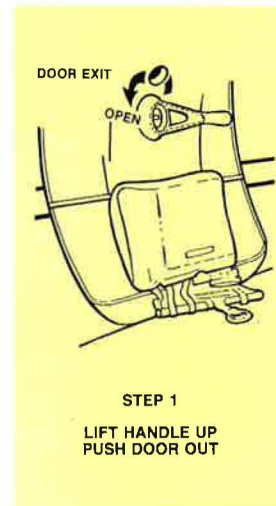

OVER WATER FLIGHT PROCEDURE

Ditching—The airplane is provided with modern, practical emergency equipment for your safety and convenience. The crewmember assigned to your compartment or section will advise you on its location and its use. In the event of a ditching, the first order will be given on the aircraft public address system to "*Prepare for Ditching.*" It will usually be given far enough in advance of the actual landing to enable you to calmly and efficiently loosen your tie and collar or remove necklaces, glasses, hats, shoes, and to discard sharp objects which you may be carrying. You will be instructed to put on a life vest, **DO NOT inflate it until you are clear of the plane.** The

next order will be: "*Stand by for Ditching.*" The crewmember in your compartment will explain the proper position to assume during the water landing. Generally two shocks will be felt, the second slightly more noticeable than the first. **Unfasten your seatbelt after the plane has come to a complete stop, but remain in your seat until you are instructed to board the life rafts.** After leaving the aircraft, your life vest may be inflated by pulling the cords with a sharp, downward pull. If your vest does not inflate automatically, it may be inflated manually by blowing into the two rubber tubes on the lapels. After the ditching is accomplished, you will board large modern rafts equipped with emergency supplies to ensure the maximum safety and comfort in these circumstances. **Once again, trained crewmembers will assist and direct you to the proper raft.**

It's Easy to Put on Your Life Vest A life vest is provided for each passenger. You'll be shown where it is. To put it on:



STEP 1
Slip it on over your head.



STEP 2
Fasten the rings on the waist strap ends to the snaps at bottom front of the vest; then grasp the pull tabs on the waist strap ends and pull snug around your waist.



STEP 3
After you leave the plane, inflate vest by pulling sharply on the two cords at bottom.



STEP 4
If the vest becomes too soft later, blow into the two rubber tubes.

OVER WATER FLIGHT PROCEDURES

Emergency Exits (Ditching) The C137 is adequately equipped with emergency facilities. Emergency exits are illustrated on the diagram. Near the center of the cabin are four removable window exits. Placards are at each exit, giving simple and clear instructions as to their use in the event of an emergency.

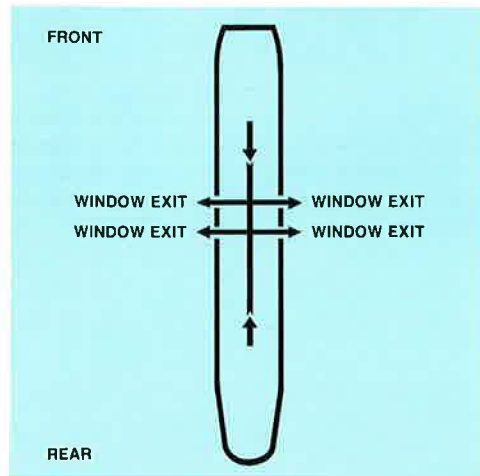

WINDOW EXITS

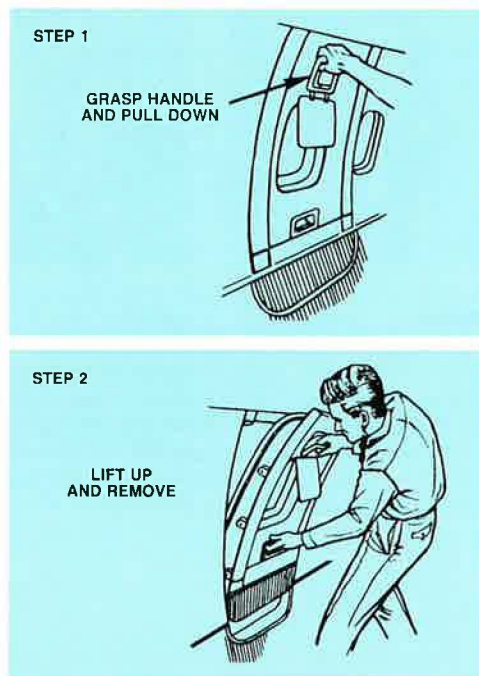

DECOMPRESSION

Decompression—Even though normally flying at an altitude of 29,000 feet or higher, the cabin, because of a pressurization system, is maintained at a 3000 to 5000 foot level. In the unlikely event of the pressurization system failing, oxygen masks which are located in the overhead passenger service unit at each seat will fall out. It is an indication to you that the aircraft cabin has reached an altitude of 14,000 feet or higher and the use of oxygen is needed. The action of pulling the mask to your face automatically turns on the oxygen supply to the mask. Hold the mask to your face and breathe normally; the Flight Attendant will advise you when the need for oxygen is no longer required.

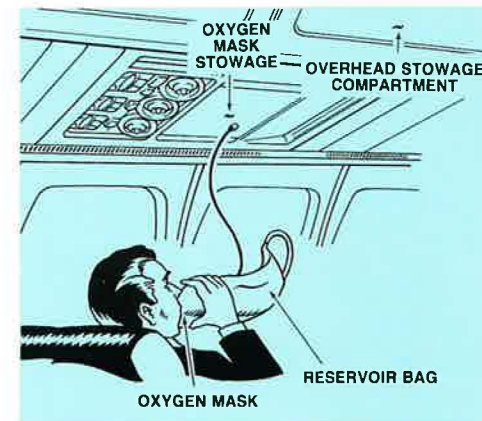

SEAT BELTS

Move around as much as you like in the Cabin while the seat belt sign is off. We suggest, however, that you keep your seat belt loosely fastened while in your seats. Of course, seat belts must be fastened any time the seat belt sign is on.

NO SMOKING

When the "NO SMOKING" sign is off, you may smoke while seated anywhere in the Cabin or state room. Whenever the "NO SMOKING" sign comes on, extinguish all smoking materials.

Have a Pleasant Flight . . .



ABOARD

Air Force One

OUR DESTINATION IS KLAMATH FALLS, OREGON.

THE EXPECTED ARRIVAL TIME IS 11:00 A.M.

TIME CHANGE ON THIS LEG: NONE.

OUR FLIGHT ALTITUDE WILL BE 25,000 FEET,

AND OUR SPEED WILL AVERAGE 480 M.P.H.

WE WILL FLY OVER RENO, NEVADA.

DESTINATION WEATHER FORECAST

CONDITIONS: CLOUDY, BREEZY AND COOL WITH
LIGHT RAIN.

TEMPERATURE:

42°